





OLIflex D.P. inox 25, rame 25

Il sistema di scarico ad elementi modulari, con interposta lana minerale ad alta densità, idoneo per l'evacuazione di fumi provenienti da generatori a gas, gasolio, legna e pellet è disponibile nella versione rame o verniciata, rame martellato o di altro colore RAL.

The chimney system based on modular elements, with high-density mineral wool in between, ideal for the evacuation of fumes coming from gas, diesel, wood and pellet generators. It is available in copper or varnished version, hammered copper or any other colour available in RAL range.

Guarnizione compresa e premontata. - Silicon gasket is included and already installed.



BIM - libreria disegni
BIM - drawing library



Documentazione online
Documentation online

Senza guarnizione
Without gasket



Con guarnizione
With gasket



Sistema OLIflex D.P. inox 25

Il sistema OLIflex D.P. inox 25 ad elementi modulari a sezione circolare con interposta lana minerale ad alta densità è realizzato con saldatura longitudinale continua al micro plasma. La parete interna, a contatto con i fumi, è realizzata in acciaio Inox AISI 316 L BA, mentre quella esterna è realizzata in acciaio Inox AISI 304 BA o nelle versioni in rame o verniciata rame martellato o verniciata di colore scelto dalla mazzetta RAL.

OLIflex D.P. inox 25 è stato certificato per ricevere i fumi provenienti da generatori a GAS, gasolio e legna, compreso il pellet.

- Le norme UNI ed EN, sulle canne fumarie, obbligano all'installazione dei sistemi a doppia parete, isolati/coibentati, se collocati all'esterno di un edificio, alle intemperie. Sempre le normative vigenti impongono l'obbligo d'installare i sistemi a doppia parete, isolati/coibentati, per attraversare solai o tetti realizzati con materiale combustibile.
- Generalmente la coibentazione, fra la parete interna e quella esterna, è realizzata con lana di roccia ad alta densità di spessore 25 mm, ma c'è la possibilità, per generatori con temperatura dei fumi molto elevata e su richiesta, di avere la coibentazione di spessore 50 mm o 75 mm con lana di roccia o coibentazione mista con fibra ceramica, a contatto con la parete interna e lana di roccia, a contatto con la parete esterna.
- Il sistema OLIflex D.P. inox 25, dal Ø 80/130 mm al Ø 200/250 mm non ha bisogno di fascetta di sicurezza perché, la parete esterna, è realizzata con il sistema, brevettato, a filetto con quattro principi, testato a flessione, compressione e trazione, sicuro e di facilissima installazione. L'innesto fra i moduli avviene con il sistema a bicchiere, maschio-femmina e guarnizione siliconica, a triplo labbro, già inserita negli elementi.
- Per i diametri Ø 250/300 mm fino al Ø 400/450 mm, il sistema è realizzato con tenuta meccanica ottenuta con una fascetta di sicurezza. La tenuta alla pressione ed alle condense è realizzata tramite una guarnizione siliconica a tre labbra che dal Ø 250/300 in poi è posta sul lato maschio della parete interna.
- Tutti i sistemi "OLIflex D.P. inox 25" realizzati con superficie esterna in rame, sono prodotti con innesto a bicchiere, maschio e femmina e sede per l'alloggiamento della fascetta di sicurezza. Non è possibile realizzare la tenuta meccanica, della superficie esterna in rame, senza fascetta di sicurezza, a causa di un eccesso di lavorazioni che possono creare delle cricature sulla saldatura.
- Le caratteristiche tecnico funzionali del sistema "OLIflex D.P. inox 25" sono le seguenti:
 1. UNI EN 1856/1 T200 - P1 - W - V2 - L50050 - O00 con guarnizione.
 2. UNI EN 1856/1 T600 - N1 - D - V2 - L50050 - G65 senza guarnizione.

The OLIflex D.P. inox 25 system

With circular section modular elements and with an interposed high density mineral wool the OLIflex D.P. inox 25 system is realized with micro plasma continuous longitudinal welding. The inner wall, in contact with the smoke, is made of stainless steel AISI 316 L BA, while the outer one is made of stainless steel AISI 304 BA or, for the customized finishing, of copper, painted hammered copper or painted in one color chosen from the RAL bribe.

OLIflex D.P. inox 25 was certified to receive the smoke from gas, diesel and wood, including pellets, generators.

- *UNI and EN norms about smoke discharge systems, require the installation, if they are placed outside a building, of the double-wall type, insulated against weathering. Moreover, the regulations in force require to install the systems with double wall, insulated, to cross floors or roofs made of combustible material.*
- *Generally the insulation, between the inner wall and the outer, is realized with high density 25 mm thick rock wool; however there is the possibility, for generators with very high flue gas temperature and on request, to have a 50 mm or 75 mm thick insulation with rock wool insulation or mixed with ceramic fiber, in contact with the inner wall, and rock wool, in contact with the outer wall.*
- *The OLIflex D.P. inox 25 system, from Ø 80/130 mm until Ø 200/250 mm does not need safety clamp because, the outer wall is realized with the patented system at welt with four principles, tested in bending, compression and tension, safe and easy to install. The coupling between modules is done with the glass-system, male-female and silicone seal, triple lip, already included in the elements.*
- *For diameters Ø 250/300 mm up to Ø 400/450 mm, the system is constructed with mechanical seal obtained with a safety clamps. The tightness and condensation at the pressure is realized with a silicone gasket to three lips that from Ø 250/300 onwards is placed on the male side of the inner wall.*
- *All "OLIflex D.P. inox 25" systems with outer surface in copper, are produced with snap-on glass system, male and female and seat for housing of the safety clamp. It is not possible to realize the mechanical seal on the outer surface of the copper with no safety clamps because of an excess of work which can create cracking on welding.*
- *The technical and functional features of the OLIflex D.P. inox 25 system are as follows:*
 1. *UNI EN 1856/1 T200 - P1 - W - V2 - L50050 - O00 seal.*
 2. *UNI EN 1856/1 T600 - N1 - D - V2 - L50050 - G65 without seal.*

ZERTIFIKAT ◆ CERTIFICATE ◆ 認証証書 ◆ CERTIFICADO ◆ CERTIFICAT

Notified Body
Nr. 0036



Industrie Service

Certificate of conformity of the factory production control

0036 CPR 91287 002
Revision 01

In compliance with Regulation 305/2011/EU of the European Parliament and of the Council of 9 March 2011 (the Construction Products Regulation or CPR), this certificate applies to the construction product

System chimney type OLIFLEX D.P. 25 Inox models

| | | |
|------------------------|-----------|-------------------------|
| model P25 DN 80-400 | EN 1856-1 | T200 P1 W V2 L50050 O00 |
| model N25 DN 80-300 | EN 1856-1 | T600 N1 D V2 L50050 G65 |
| DN 350-400 | EN 1856-1 | T600 N1 D V2 L50050 G98 |

produced by

Oli s.r.l.
Località Piani di Mura
25070 Casto (BS), Italy

in the manufacturing plant

Factory number 4

This certificate attests that all provisions concerning the assessment and verification of constancy of performance described in Annex ZA of the standard

EN 1856-1:2009-06

under system 2+ are applied and that the factory production control fulfils all the prescribed requirements set out above.

The determination of the product type on the basis of type testing is documented.

This certificate was first issued on 2012-09-10 and will remain valid as long as the test methods and/or factory production control requirements included in the harmonised standard, used to assess the performance of the declared characteristics, do not change, and the product, and the manufacturing conditions in the plant are not modified significantly.

Munich, 2016-12-02

Johannes Steiglechner
Leiter Zertifizierungsstelle Bauprodukte (EG)

TÜV SÜD INDUSTRIE SERVICE GMBH, WESTENDSTRASSE 199, 80686 MUNICH, GERMANY



Voce di capitolato – Scheda tecnica di prodotto

OLIflex D.P. 25 Inox – ISOLATO Lana

Sistema camino in elementi modulari, di sezione circolare a doppia parete coibentato; idoneo ad ogni impianto di tipo civile o industriale e per ogni combustibile (V2 secondo UNITS 11278), per funzionamento sia a secco che in condensazione (W).

• Gamma diametri da 80 mm. a 400 mm.

- Parete interna in acciaio inox AISI 316L (classificato secondo EN 10088 nr. 1.4404) di spessore 0.5 mm. con finitura 2R lucida a specchio, avente grado di resistenza alla corrosione di tipo V2.
- Parete esterna di spessore 0.5 mm., realizzata in acciaio inox AISI 304 (classificato secondo EN 10088 nr 1.4301) con finitura esterna 2R lucida a specchio.
- Finitura superficiale esterna, lucida a specchio o verniciatura in tinta codici RAL.
- Ponte termico totalmente assente.
- Bicchiere interno del tipo maschio/femmina con altezza 60 mm. ad elevata stabilità.
- Bicchiere esterno a chiusura meccanica mediante **serraggio degli elementi con sistema a vite conica brevettato** e assenza di fascetta stringitubo per il bloccaggio elementi (diam. Int. 80 mm. al 200 mm.), serraggio con fascetta stringitubo per diam. da 250 mm. al 400 mm.
- Rotazione elementi orientabile sui quattro assi 0° - 90° - 180° - 270°
- Tenuta con guarnizione fino a **200 Pa (classe P1)** di tipo silconico, installata nell'interno del bicchiere femmina e conforme alla norma EN 14241, per i **diametri da 80 mm. a 400 mm.**
- Tenuta senza guarnizione fino a **40 Pa (classe N1)**, per i **diametri da 80 mm. a 400 mm.**
- Isolamento termico del camino avente spessore di 25 mm. e realizzato mediante coppella in lana di roccia ad elevata densità (110 Kg/mc.).
- Isolamento termico "passaggio tetto", testato contemporaneamente al camino, avente spessore di 65 mm. e realizzato mediante doppio strato isolante, il primo con materassino di 15 mm. a densità 128 Kg/mc., in fibra per alte temperature, e il secondo con lana di roccia di 40 mm. a densità 110 Kg/mc.
- Temperatura massima raggiungibile dalle superfici combustibili adiacenti durante la prova di resistenza al calore inferiore a 65°C per il camino e 56°C per il "passaggio tetto".
- Temperatura massima raggiungibile dalle superfici combustibili adiacenti durante la prova di shock termico inferiore a 94°C per il camino e 75°C per il "passaggio tetto".
- Distanza dal **"passaggio tetto"**, a intercapedine ventilata, dei mat. combustibili dichiarata **"a contatto"**

Gli elementi, ai fini della marcatura CE, sono dichiarati conformi secondo EN 1856-1 nelle seguenti condizioni:

Sistema camino certificato CE secondo lo standard EN 1856-1 – nr. 0036 CPD 91287 002

| | | |
|-----------------------------|-------------------------|-------------------------------------|
| Con guarnizione di tenuta | T200 P1 W V2 L50050 O00 | (diam. 80-400 mm.) condens. e secco |
| Senza guarnizione di tenuta | T600 N1 D V2 L50050 G65 | (diam. 80-300 mm.) a secco |
| Senza guarnizione di tenuta | T600 N1 D V2 L50050 G98 | (diam. 350-400 mm.) a secco |

Con accessorio speciale "PASSAGGIO TETTO FIRE PROTECTION" – designazione da test report

| | | |
|-----------------------------|---------------------------------------|---------|
| Senza guarnizione di tenuta | T600 N1 D V2 L500050 G00 ^a | a secco |
|-----------------------------|---------------------------------------|---------|

a) Classificazione con utilizzo dell'elemento speciale "PASSAGGIO TETTO" con intercapedine ventilata

OLI srl - Località Piani di Mura - 25070 Casto (Brescia) Italia - Tel. +39 0365/890.611 - Fax +39 0365/879.922
e-mail: info@olisrl.it - www.oli-world.com

Cap. Soc. € 1.000.000 i.v. - Reg. Imprese di Brescia 00923140115 - Reg. Rea 0360945 C.C.I.A.A. Brescia - Mecc. BS058831
Cod. Fisc. 00923140115 - Part. IVA IT 01853380986

"Oli S.r.l. soggetta all'attività di direzione e coordinamento da parte di Oli - Sistemas Sanitários S.A. Codice Fiscale 96014610172"

S-05/7 rev.8 del 03/18

Azienda con
Sistema Qualità
certificata da:



Scheda tecnica

Technical specification

| Caratteristiche generali General characteristics | | | | | | | | | | |
|---|---|------|------|------|------|------|------|------|------|------|
| Diametro interno <i>Internal diameter</i> | 80 | 100 | 130 | 150 | 180 | 200 | 250 | 300 | 350 | 400 |
| Sviluppo parete interna <i>Internal wall develop</i> | 251 | 314 | 408 | 471 | 567 | 630 | 785 | 942 | 1099 | 1256 |
| Diametro esterno <i>External diameter</i> | 130 | 150 | 180 | 200 | 230 | 250 | 300 | 350 | 400 | 450 |
| Sviluppo parte esterna <i>External wall develop</i> | 408 | 471 | 567 | 630 | 723 | 785 | 942 | 1099 | 1256 | 1413 |
| Resistenza termica (m ² k/W) <i>Thermal resistance (m²k/W)</i> | 0,36 | 0,37 | 0,39 | 0,40 | 0,41 | 0,41 | 0,42 | 0,42 | 0,43 | 0,43 |
| Parete interna <i>Inner wall</i> | | | | | | | | | | |
| Tipo di materiale <i>Type of material</i> | Acciaio inox AISI 316 L BA finitura lucida <i>Polished stainless steel AISI 316 L BA</i> | | | | | | | | | |
| Spessore lamiera <i>Sheet thickness</i> | min 0,4/0,5 (a richiesta - <i>upon demand</i> 0,6/0,8) | | | | | | | | | |
| Guarnizione gomma siliconica <i>Silicon seal</i> | da D 80 a D 400 fornita e inserita <i>from D 80 to D 400 supplied and inserted</i> | | | | | | | | | |
| Parete esterna <i>External wall</i> | | | | | | | | | | |
| Tipo di materiale <i>Type of material</i> | Acciaio inox AISI 304 BA finitura lucida <i>Finish polished stainless steel AISI 304 BA</i> | | | | | | | | | |
| Spessore lamiera <i>Sheet thickness</i> | min 0,4 (a richiesta - <i>upon demand</i> 0,6/0,8/1,0) | | | | | | | | | |
| Superficie esterna <i>External surface</i> | Inox, rame, inox verniciato, color rame martellato <i>Stainless steel - copper - varnished stainless steel</i> | | | | | | | | | |
| Coibentazione <i>Insulation</i> | | | | | | | | | | |
| Tipo di materiale <i>Type of material</i> | Lana minerale ad alta densità <i>High density mineral wool</i> | | | | | | | | | |
| Reazione al fuoco <i>Reaction to fire</i> | Non combustibile <i>Not combustible</i> | | | | | | | | | |
| Densità (kg/m ³) <i>Density (kg/m³)</i> | 110 | | | | | | | | | |
| Condizioni di utilizzo <i>Use conditions</i> | | | | | | | | | | |
| Combustibile <i>Fuel</i> | Gas metano, GPL, gasolio, legna <i>Methane gas, GPL, diesel oil, wood</i> | | | | | | | | | |
| Temperatura massima <i>Maximum temperature</i> | 200°C con guarnizione - 600°C senza guarnizione <i>200°C with seal - 600°C without seal</i> | | | | | | | | | |
| Utilizzo ad umido <i>Use in humid</i> | Sì (con guarnizione inserita) <i>Yes (with seal inserted)</i> | | | | | | | | | |
| Utilizzo in pressione <i>Use under pressure</i> | Sì (con guarnizione inserita) <i>Yes (with seal inserted)</i> | | | | | | | | | |

| Certificazioni <i>Certifications</i> | |
|--|---|
| Marchatura CE EN1856/1 <i>CE mark EN1856/1</i> | Certificato - <i>Certificate</i> n°0036-CPD-91287-002 |
| Conformità dei materiali <i>Conformity of materials</i> | DM 37/08 - UNI TS 11278 EN 1443 EN 1856/1 |
| Sistema di qualità <i>Quality system</i> | UNI EN ISO 9001:2008 - TÜV SÜD |
| Certificazione di prodotto <i>Product certification</i> | TÜV SÜD |
| Prove di collaudo <i>Test</i> | TÜV SÜD |

Esempi di montaggio Assembly examples

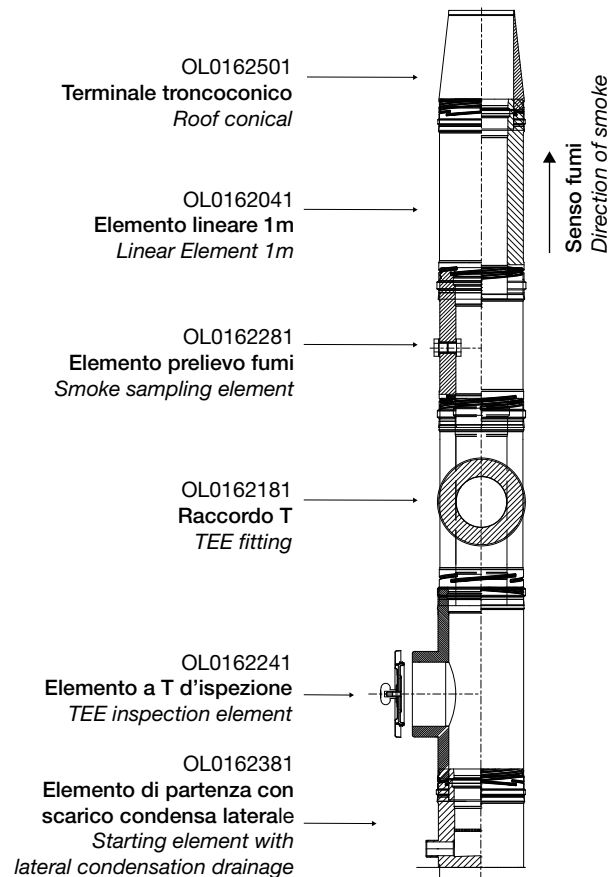
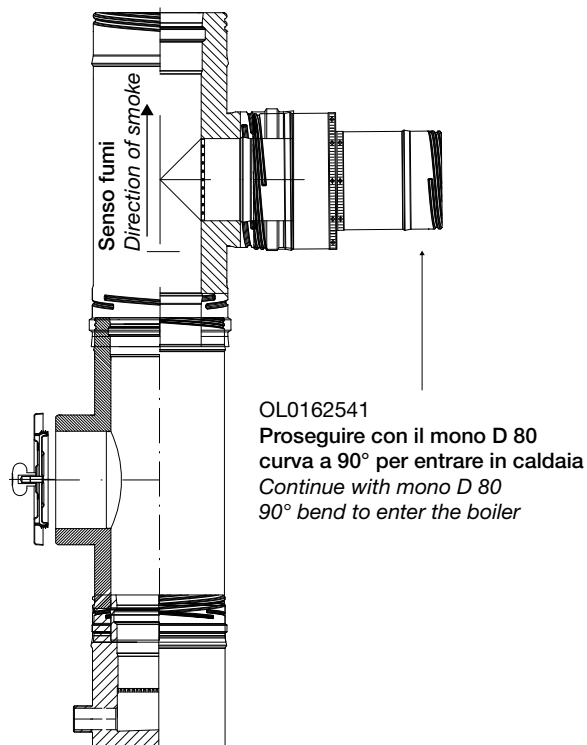
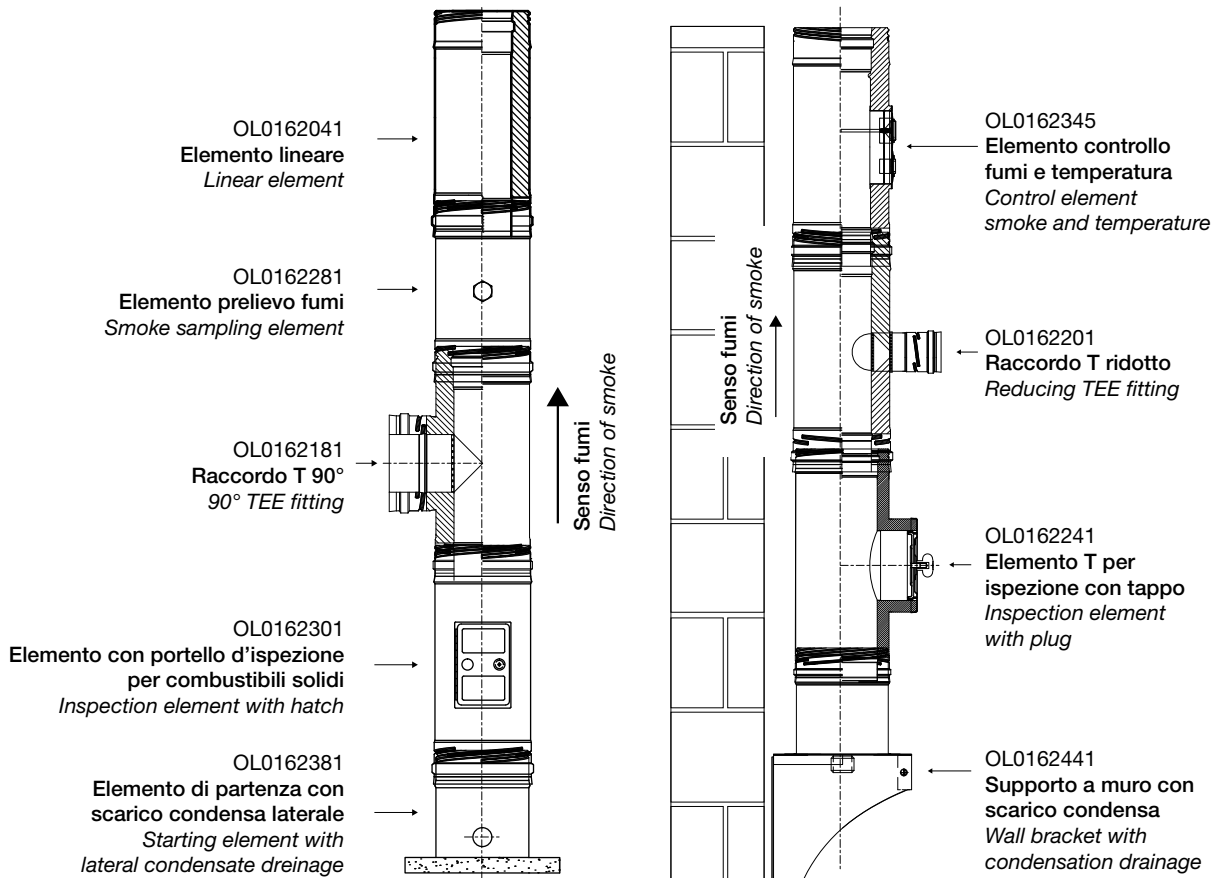

Attraversamento materiale combustibile

Passage through combustible material

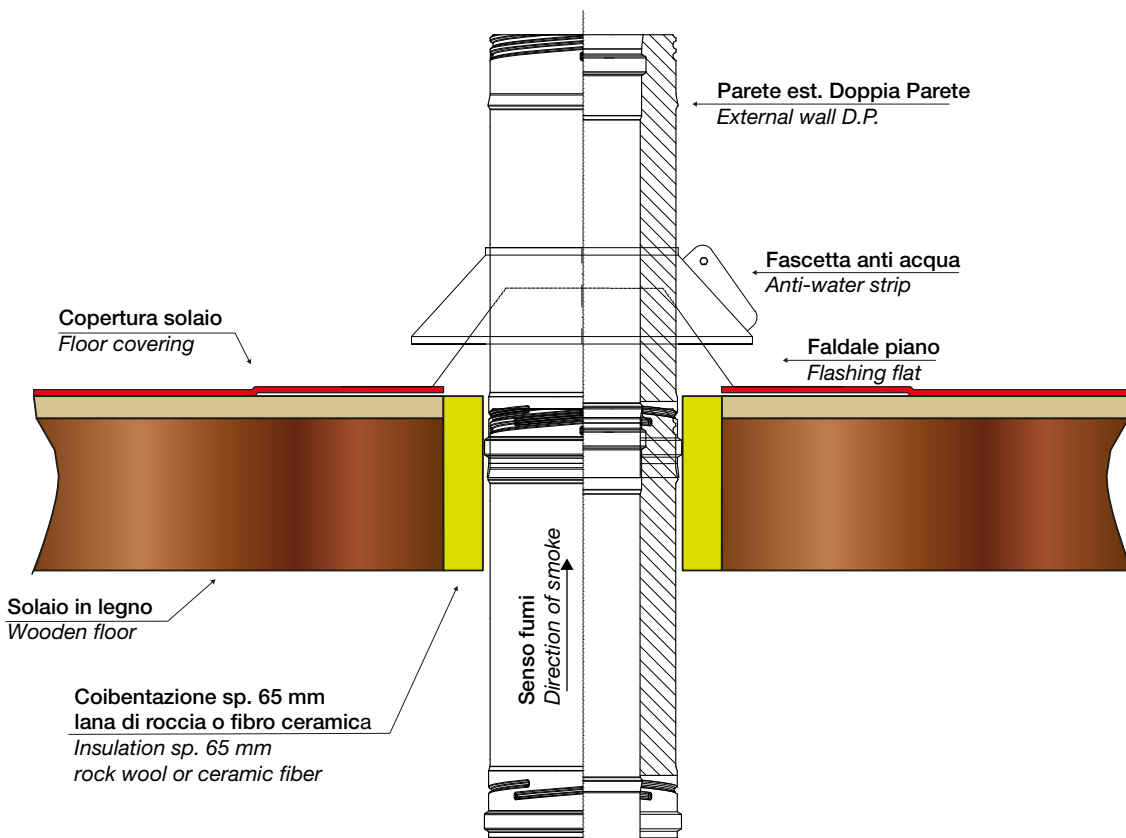
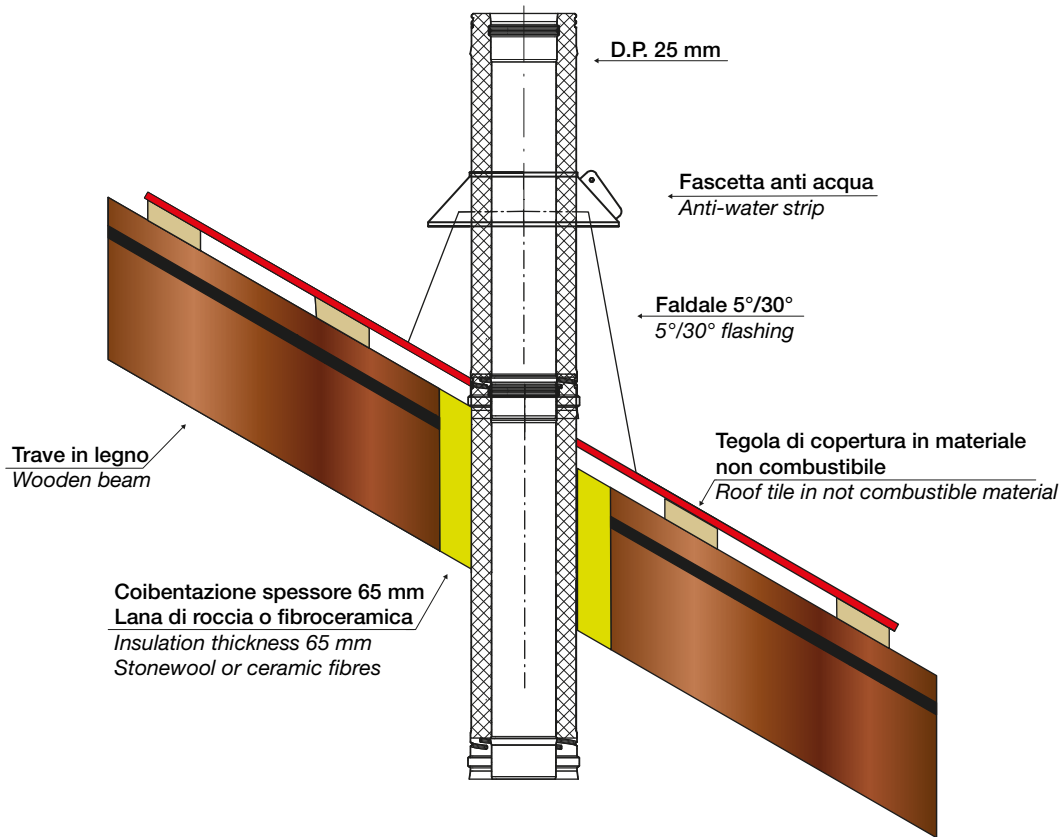

- Elemento lineare.
- *Linear element.*

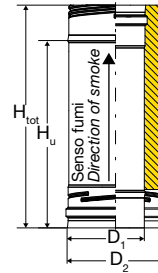

Avvitare - Twist

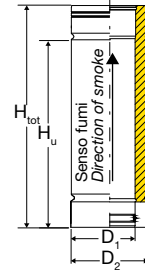

Tradizionale dal Ø 250 al Ø 400 mm
Traditional from Ø 250 to Ø 400 mm

1 m

| Cod. inox | Cod. rame/copper | D ₁ | D ₂ | H _{tot} | H _u | S |  |
|--------------|------------------|----------------|----------------|------------------|----------------|----|---|
| OL0162041 | OL0162041RA* | 80 | 130 | 994 | 944 | 25 | 1 |
| OL0162042 | OL0162042RA* | 100 | 150 | 994 | 944 | 25 | 1 |
| OL0162043 | OL0162043RA* | 130 | 180 | 994 | 944 | 25 | 1 |
| OL0162044 | OL0162044RA* | 150 | 200 | 994 | 944 | 25 | 1 |
| OL0162045 | OL0162045RA* | 180 | 230 | 994 | 944 | 25 | 1 |
| OL0162046 | OL0162046RA* | 200 | 250 | 994 | 944 | 25 | 1 |
| OL0162047CL* | OL0162047RA* | 250 | 300 | 994 | 940 | 25 | 1 |
| OL0162048CL* | OL0162048RA* | 300 | 350 | 994 | 940 | 25 | 1 |
| OL0162049CL* | OL0162049RA* | 350 | 400 | 994 | 940 | 25 | 1 |
| OL0162050CL* | OL0162050RA* | 400 | 450 | 994 | 940 | 25 | 1 |

*Aggiungere fascetta stringitubo. - Hose locking band to add. (pag. 165).

0,50 m

| Cod. inox | Cod. rame/copper | D ₁ | D ₂ | H _{tot} | H _u | S |  |
|--------------|------------------|----------------|----------------|------------------|----------------|----|---|
| OL0162021 | OL0162021RA* | 80 | 130 | 494 | 444 | 25 | 1 |
| OL0162022 | OL0162022RA* | 100 | 150 | 494 | 444 | 25 | 1 |
| OL0162023 | OL0162023RA* | 130 | 180 | 494 | 444 | 25 | 1 |
| OL0162024 | OL0162024RA* | 150 | 200 | 494 | 444 | 25 | 1 |
| OL0162025 | OL0162025RA* | 180 | 230 | 494 | 444 | 25 | 1 |
| OL0162026 | OL0162026RA* | 200 | 250 | 494 | 444 | 25 | 1 |
| OL0162027CL* | OL0162027RA* | 250 | 300 | 494 | 440 | 25 | 1 |
| OL0162028CL* | OL0162028RA* | 300 | 350 | 494 | 440 | 25 | 1 |
| OL0162029CL* | OL0162029RA* | 350 | 400 | 494 | 440 | 25 | 1 |
| OL0162030CL* | OL0162030RA* | 400 | 450 | 494 | 440 | 25 | 1 |

*Aggiungere fascetta stringitubo. - Hose locking band to add. (pag. 165).

- Elemento lineare.
- *Linear element.*

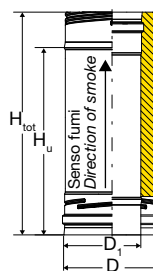

Avvitare - Twist

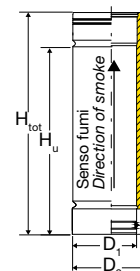

Tradizionale dal Ø 250 al Ø 400 mm
Traditional from Ø 250 to Ø 400 mm

0,25 m

| Cod. inox | Cod. rame/copper | D ₁ | D ₂ | H _{tot} | H _u | S | |
|--------------|------------------|----------------|----------------|------------------|----------------|----|---|
| OL0162001 | OL0162001RA* | 80 | 130 | 244 | 194 | 25 | 1 |
| OL0162002 | OL0162002RA* | 100 | 150 | 244 | 194 | 25 | 1 |
| OL0162003 | OL0162003RA* | 130 | 180 | 244 | 194 | 25 | 1 |
| OL0162004 | OL0162004RA* | 150 | 200 | 244 | 194 | 25 | 1 |
| OL0162005 | OL0162005RA* | 180 | 230 | 244 | 194 | 25 | 1 |
| OL0162006 | OL0162006RA* | 200 | 250 | 244 | 194 | 25 | 1 |
| OL0162007CL* | OL0162007RA* | 250 | 300 | 244 | 190 | 25 | 1 |
| OL0162008CL* | OL0162008RA* | 300 | 350 | 244 | 190 | 25 | 1 |
| OL0162009CL* | OL0162009RA* | 350 | 400 | 244 | 190 | 25 | 1 |
| OL0162010CL* | OL0162010RA* | 400 | 450 | 244 | 190 | 25 | 1 |

*Aggiungere fascetta stringitubo. - Hose locking band to add. (pag. 165).

- Elemento variabile.
- *Adjustable element.*

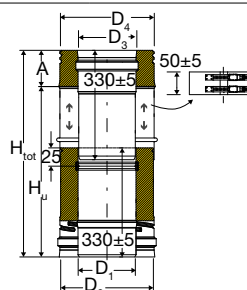

Avvitare - Twist

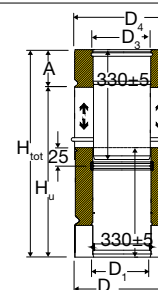

Tradizionale da Ø 250 al Ø 400 mm
Traditional from Ø 250 to Ø 400 mm

| Cod. inox | Cod. rame/copper | D ₁ | D ₂ | D ₃ | D ₄ | A±3 mm | H _{u min} | H _{u max} | H _{tot min} | H _{tot max} | |
|--------------|------------------|----------------|----------------|----------------|----------------|--------|--------------------|--------------------|----------------------|----------------------|---|
| OL0162061 | OL0162061RA* | 80 | 128 | 78 | 130 | 50 | 350 | 530 | 400 | 580 | 1 |
| OL0162062 | OL0162062RA* | 100 | 148 | 98 | 150 | 50 | 350 | 530 | 400 | 580 | 1 |
| OL0162063 | OL0162063RA* | 130 | 178 | 128 | 180 | 50 | 350 | 530 | 400 | 580 | 1 |
| OL0162064 | OL0162064RA* | 150 | 198 | 148 | 200 | 50 | 350 | 530 | 400 | 580 | 1 |
| OL0162065 | OL0162065RA* | 180 | 228 | 178 | 230 | 50 | 350 | 530 | 400 | 580 | 1 |
| OL0162066 | OL0162066RA* | 200 | 248 | 198 | 250 | 50 | 350 | 530 | 400 | 580 | 1 |
| OL0162067CL* | OL0162067RA* | 250 | 298 | 248 | 300 | 54 | 260 | 390 | 314 | 444 | 1 |
| OL0162068CL* | OL0162068RA* | 300 | 350 | 298 | 350 | 54 | 260 | 390 | 314 | 444 | 1 |
| OL0162069CL* | OL0162069RA* | 350 | 400 | 348 | 400 | 54 | 260 | 390 | 314 | 444 | 1 |
| OL0162070CL* | OL0162070RA* | 400 | 450 | 398 | 450 | 54 | 260 | 390 | 314 | 444 | 1 |

*Aggiungere fascetta stringitubo. - Hose locking band to add. (pag. 165).

- Curva 15°.
- 15° elbow.

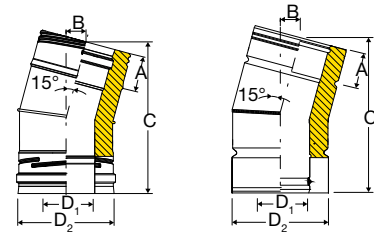

Avvitare - Twist Tradizionale da Ø 250 al Ø 400 mm
Traditional from Ø 250 to Ø 400 mm

| Cod. inox | Cod. rame/copper | D ₁ | D ₂ | A | B±5 mm | C±5 mm | |
|--------------|------------------|----------------|----------------|----|--------|--------|---|
| OL0162101 | OL0162101RA* | 80 | 130 | 50 | 23 | 174 | 1 |
| OL0162102 | OL0162102RA* | 100 | 150 | 50 | 23 | 177 | 1 |
| OL0162103 | OL0162103RA* | 130 | 180 | 50 | 24 | 181 | 1 |
| OL0162104 | OL0162104RA* | 150 | 200 | 50 | 24 | 183 | 1 |
| OL0162105 | OL0162105RA* | 180 | 230 | 50 | 25 | 187 | 1 |
| OL0162106 | OL0162106RA* | 200 | 250 | 50 | 25 | 190 | 1 |
| OL0162107CL* | OL0162107RA* | 250 | 300 | 54 | 24 | 199 | 1 |
| OL0162108CL* | OL0162108RA* | 300 | 350 | 54 | 25 | 206 | 1 |
| OL0162109CL* | OL0162109RA* | 350 | 400 | 54 | 26 | 212 | 1 |
| OL0162110CL* | OL0162110RA* | 400 | 450 | 54 | 24 | 219 | 1 |

*Aggiungere fascetta stringitubo. - Hose locking band to add. (pag. 165).

Esempi di spostamenti - Displacement examples

Fig. A

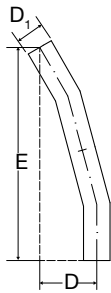

2 curve montate a 30°
2 bends mounted at 30°

Fig. B

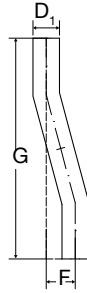

Spostamento 2 curve a 15°
Displacement of 2 bends at 15°

Fig. C

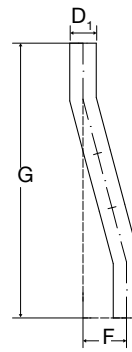

Spostamento 2 curve a 15° + elemento
Displacement of 2 bends at 15° + element

| Fig. A | | | Fig. B | | Fig. C | | | | | |
|----------------|----|-----|--------|-----|--------|-------|-------|-------|--------|--------|
| D ₁ | D | E | F | G | F 250 | G 250 | F 500 | G 500 | F 1000 | G 1000 |
| 80 | 77 | 288 | 33 | 300 | 83 | 487 | 148 | 729 | 277 | 1212 |
| 100 | 79 | 293 | 34 | 305 | 84 | 492 | 148 | 734 | 278 | 1217 |
| 130 | 81 | 301 | 35 | 313 | 85 | 500 | 150 | 742 | 279 | 1225 |
| 150 | 82 | 306 | 35 | 318 | 85 | 505 | 150 | 747 | 280 | 1230 |
| 180 | 84 | 313 | 36 | 326 | 87 | 513 | 151 | 755 | 281 | 1238 |
| 200 | 85 | 318 | 37 | 331 | 87 | 518 | 152 | 760 | 281 | 1243 |
| 250 | 82 | 323 | 36 | 336 | 85 | 519 | 150 | 761 | 279 | 1244 |
| 300 | 86 | 336 | 37 | 349 | 87 | 532 | 151 | 774 | 281 | 1257 |
| 350 | 89 | 348 | 39 | 361 | 88 | 545 | 153 | 786 | 282 | 1269 |
| 400 | 92 | 361 | 41 | 374 | 90 | 558 | 155 | 799 | 284 | 1282 |

- Curva 30°.
- 30° elbow.

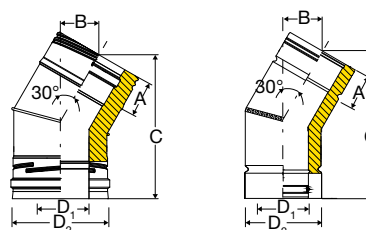

Avvitare - Twist

Tradizionale da Ø 250 al Ø 400 mm
Traditional from Ø 250 to Ø 400 mm

| Cod. inox | Cod. rame/copper | D ₁ | D ₂ | A | B±5 mm | C±5 mm | |
|--------------|------------------|----------------|----------------|----|--------|--------|---|
| OL0162121 | OL0162121RA* | 80 | 130 | 50 | 49 | 182 | 1 |
| OL0162122 | OL0162122RA* | 100 | 150 | 50 | 50 | 187 | 1 |
| OL0162123 | OL0162123RA* | 130 | 180 | 50 | 52 | 194 | 1 |
| OL0162124 | OL0162124RA* | 150 | 200 | 50 | 53 | 199 | 1 |
| OL0162125 | OL0162125RA* | 180 | 230 | 50 | 55 | 207 | 1 |
| OL0162126 | OL0162126RA* | 200 | 250 | 50 | 57 | 212 | 1 |
| OL0162127CL* | OL0162127RA* | 250 | 300 | 54 | 56 | 225 | 1 |
| OL0162128CL* | OL0162128RA* | 300 | 350 | 54 | 60 | 238 | 1 |
| OL0162129CL* | OL0162129RA* | 350 | 400 | 54 | 64 | 249 | 1 |
| OL0162130CL* | OL0162130RA* | 400 | 450 | 54 | 67 | 262 | 1 |

*Aggiungere fascetta stringitubo. - Hose locking band to add. (pag. 165).

Esempi di spostamenti - Displacement examples

Fig. A

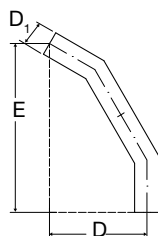

Fig. B

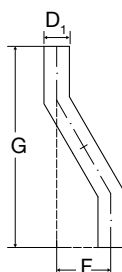
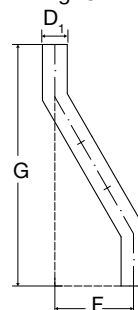

Fig. C



2 curve montate a 60°
2 bends mounted at 60°

Spostamento 2 curve a 30°
Displacement of 2 bends at 30°

Spostamento 2 curve a 30° + elemento
Displacement of 2 bends at 30° + element

| Fig. A | | | Fig. B | | | Fig. C | | | | |
|----------------|-----|-----|--------|-----|-------|--------|-------|-------|--------|--------|
| D ₁ | D | E | F | G | F 250 | G 250 | F 500 | G 500 | F 1000 | G 1000 |
| 80 | 157 | 272 | 72 | 320 | 169 | 488 | 294 | 705 | 544 | 1138 |
| 100 | 162 | 280 | 75 | 330 | 172 | 498 | 297 | 715 | 547 | 1148 |
| 130 | 169 | 293 | 79 | 345 | 176 | 513 | 301 | 730 | 551 | 1163 |
| 150 | 174 | 302 | 82 | 355 | 179 | 523 | 304 | 740 | 554 | 1173 |
| 180 | 182 | 315 | 86 | 370 | 183 | 538 | 308 | 755 | 558 | 1188 |
| 200 | 187 | 324 | 88 | 380 | 185 | 548 | 310 | 765 | 563 | 1198 |
| 250 | 185 | 336 | 88 | 392 | 183 | 557 | 308 | 774 | 558 | 1207 |
| 300 | 198 | 358 | 94 | 417 | 189 | 582 | 314 | 799 | 564 | 1232 |
| 350 | 211 | 377 | 101 | 441 | 196 | 605 | 321 | 822 | 571 | 1255 |
| 400 | 223 | 399 | 107 | 466 | 202 | 630 | 327 | 847 | 577 | 1280 |

- Curva 45°.
- 45° elbow.

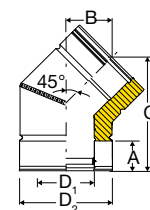
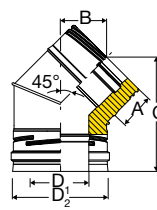

Avvitare - Twist Tradizionale da Ø 250 al Ø 400 mm
Traditional from Ø 250 to Ø 400 mm

| Cod. inox | Cod. rame/copper | D ₁ | D ₂ | A | B±5 mm | C±5 mm | |
|--------------|------------------|----------------|----------------|----|--------|--------|---|
| OL0162141 | OL0162141RA* | 80 | 130 | 50 | 76 | 183 | 1 |
| OL0162142 | OL0162142RA* | 100 | 150 | 50 | 79 | 190 | 1 |
| OL0162143 | OL0162143RA* | 130 | 180 | 50 | 83 | 200 | 1 |
| OL0162144 | OL0162144RA* | 150 | 200 | 50 | 86 | 207 | 1 |
| OL0162145 | OL0162145RA* | 180 | 230 | 50 | 90 | 218 | 1 |
| OL0162146 | OL0162146RA* | 200 | 250 | 50 | 93 | 225 | 1 |
| OL0162147CL* | OL0162147RA* | 250 | 300 | 54 | 98 | 249 | 1 |
| OL0162148CL* | OL0162148RA* | 300 | 350 | 54 | 106 | 266 | 1 |
| OL0162149CL* | OL0162149RA* | 350 | 400 | 54 | 110 | 281 | 1 |
| OL0162150CL* | OL0162150RA* | 400 | 450 | 54 | 117 | 302 | 1 |

*Aggiungere fascetta stringitubo. - Hose locking band to add. (pag. 165).

Esempi di spostamenti - Displacement examples

Fig. A

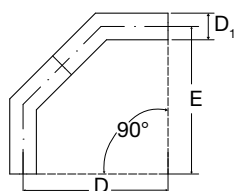

Fig. B

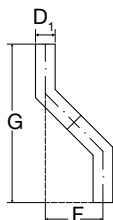
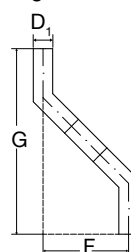

Fig. C



2 curve montate a 90°
2 bends mounted at 90°

Spostamento 2 curve a 45°
Displacement of 2 bends at 45°

Spostamento 2 curve a 45° + elemento
Displacement of 2 bends at 45° + element

| D ₁ | Fig. A | | Fig. B | | Fig. C | | | | | |
|----------------|--------|-----|--------|-----|--------|-------|-------|-------|--------|--------|
| | D | E | F | G | F 250 | G 250 | F 500 | G 500 | F 1000 | G 1000 |
| 80 | 223 | 223 | 116 | 330 | 253 | 467 | 430 | 644 | 783 | 997 |
| 100 | 233 | 233 | 122 | 344 | 259 | 481 | 436 | 658 | 789 | 1011 |
| 130 | 248 | 248 | 131 | 365 | 268 | 502 | 444 | 679 | 798 | 1033 |
| 150 | 258 | 258 | 136 | 379 | 274 | 516 | 440 | 693 | 804 | 1047 |
| 180 | 273 | 273 | 145 | 400 | 282 | 538 | 449 | 714 | 813 | 1068 |
| 200 | 283 | 283 | 151 | 415 | 288 | 552 | 465 | 729 | 819 | 1082 |
| 250 | 298 | 309 | 159 | 383 | 293 | 582 | 470 | 759 | 823 | 1113 |
| 300 | 323 | 334 | 173 | 418 | 308 | 618 | 484 | 794 | 838 | 1148 |
| 350 | 340 | 357 | 185 | 447 | 319 | 646 | 496 | 823 | 850 | 1176 |
| 400 | 367 | 387 | 202 | 487 | 336 | 687 | 513 | 863 | 867 | 1217 |

- Curva 90°.
- 90° elbow.

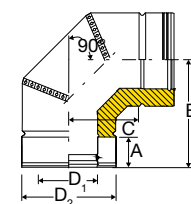
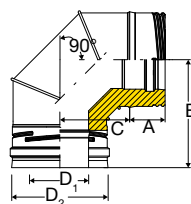

Avvitare - Twist

Tradizionale da Ø 250 al Ø 400 mm
Traditional from Ø 250 to Ø 400 mm

| Cod. inox | Cod. rame/copper | D ₁ | D ₂ | A | B±5 mm | C±5 mm | |
|--------------|------------------|----------------|----------------|----|--------|--------|---|
| OL0162161 | OL0162161RA* | 80 | 130 | 50 | 171 | 121 | 1 |
| OL0162162 | OL0162162RA* | 100 | 150 | 50 | 181 | 131 | 1 |
| OL0162163 | OL0162163RA* | 130 | 180 | 50 | 196 | 146 | 1 |
| OL0162164 | OL0162164RA* | 150 | 200 | 50 | 206 | 156 | 1 |
| OL0162165 | OL0162165RA* | 180 | 230 | 50 | 228 | 178 | 1 |
| OL0162166 | OL0162166RA* | 200 | 250 | 50 | 238 | 188 | 1 |
| OL0162167CL* | OL0162167RA* | 250 | 300 | 54 | 261 | 190 | 1 |
| OL0162168CL* | OL0162168RA* | 300 | 350 | 54 | 286 | 215 | 1 |
| OL0162169CL* | OL0162169RA* | 350 | 400 | 54 | 332 | 261 | 1 |
| OL0162170CL* | OL0162170RA* | 400 | 450 | 54 | 378 | 307 | 1 |

*Aggiungere fascetta stringitubo. - Hose locking band to add. (pag. 165).

Esempi di spostamenti - Displacement examples

Fig. A

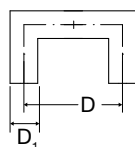

2 curve montate a 180°
2 bends mounted at 180°

Fig. B

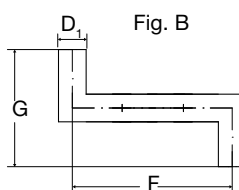

Spostamento 2 curve a 90° + elemento
Displacement of 2 bends at 90° + element

| Fig. A | | | Fig. B | | | | | | |
|----------------|-----|-----|--------|-------|-------|-------|-------|--------|--------|
| D ₁ | D | F | G | F 250 | G 250 | F 500 | G 500 | F 1000 | G 1000 |
| 80 | 292 | 292 | 342 | 486 | 342 | 736 | 342 | 1236 | 342 |
| 100 | 312 | 312 | 362 | 506 | 362 | 756 | 362 | 1256 | 362 |
| 130 | 342 | 342 | 392 | 536 | 392 | 786 | 392 | 1286 | 392 |
| 150 | 362 | 362 | 412 | 556 | 412 | 806 | 412 | 1306 | 412 |
| 180 | 406 | 406 | 546 | 600 | 546 | 850 | 546 | 1350 | 546 |
| 200 | 426 | 426 | 476 | 620 | 476 | 870 | 476 | 1370 | 476 |
| 250 | 440 | 440 | 505 | 630 | 505 | 880 | 505 | 1380 | 505 |
| 300 | 490 | 490 | 555 | 680 | 555 | 930 | 555 | 1430 | 555 |
| 350 | 582 | 582 | 647 | 772 | 647 | 1022 | 647 | 1522 | 647 |
| 400 | 674 | 674 | 739 | 864 | 739 | 1114 | 739 | 1614 | 739 |

- Raccordo a T 90° maschio.
- 90° male TEE.

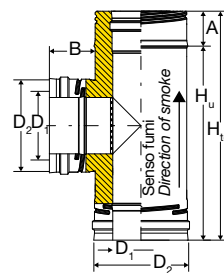

Avvitare - Twist

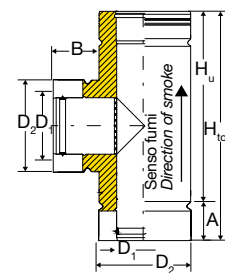

Tradizionale da Ø 250 al Ø 400 mm
Traditional from Ø 250 to Ø 400 mm

| Cod. inox | Cod. rame/copper | D ₁ | D ₂ | A | B | H _{tot} | H _u | |
|--------------|------------------|----------------|----------------|----|-----|------------------|----------------|---|
| OL0162181 | OL0162181RA* | 80 | 130 | 50 | 100 | 494 | 444 | 1 |
| OL0162182 | OL0162182RA* | 100 | 150 | 50 | 100 | 494 | 444 | 1 |
| OL0162183 | OL0162183RA* | 130 | 180 | 50 | 100 | 494 | 444 | 1 |
| OL0162184 | OL0162184RA* | 150 | 200 | 50 | 100 | 494 | 444 | 1 |
| OL0162185 | OL0162185RA* | 180 | 230 | 50 | 100 | 494 | 444 | 1 |
| OL0162186 | OL0162186RA* | 200 | 250 | 50 | 100 | 494 | 444 | 1 |
| OL0162187CL* | OL0162187RA* | 250 | 300 | 54 | 100 | 494 | 440 | 1 |
| OL0162188CL* | OL0162188RA* | 300 | 350 | 54 | 100 | 544 | 490 | 1 |
| OL0162189CL* | OL0162189RA* | 350 | 400 | 54 | 100 | 642 | 588 | 1 |
| OL0162190CL* | OL0162190RA* | 400 | 450 | 54 | 100 | 764 | 710 | 1 |

*Aggiungere fascetta stringitubo. - Hose locking band to add. (pag. 165).

- Raccordo a T 90° maschio ridotto D 80 attacco maschio.
- TEE 90° reduced fitting D 80 male.

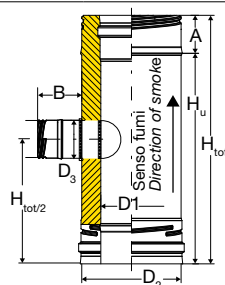

Avvitare - Twist

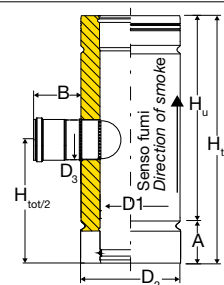

Tradizionale da Ø 250 al Ø 400 mm
Traditional from Ø 250 to Ø 400 mm

| Cod. inox | Cod. rame/copper | D ₁ | D ₂ | D ₃ | A | B | H _{tot} | H _u | |
|--------------|------------------|----------------|----------------|----------------|----|-----|------------------|----------------|---|
| OL0162201 | OL0162201RA* | 80 | 130 | 80 | 50 | 100 | 244 | 194 | 1 |
| OL0162202 | OL0162202RA* | 100 | 150 | 80 | 50 | 100 | 244 | 194 | 1 |
| OL0162203 | OL0162203RA* | 130 | 180 | 80 | 50 | 100 | 244 | 194 | 1 |
| OL0162204 | OL0162204RA* | 150 | 200 | 80 | 50 | 100 | 244 | 194 | 1 |
| OL0162205 | OL0162205RA* | 180 | 230 | 80 | 50 | 100 | 244 | 194 | 1 |
| OL0162206 | OL0162206RA* | 200 | 250 | 80 | 50 | 100 | 244 | 194 | 1 |
| OL0162207CL* | OL0162207RA* | 250 | 300 | 80 | 54 | 90 | 244 | 190 | 1 |
| OL0162208CL* | OL0162208RA* | 300 | 350 | 80 | 54 | 90 | 244 | 190 | 1 |

*Aggiungere fascetta stringitubo. - Hose locking band to add. (pag. 165).

- Apertura di compensazione con rete per sistemi collettivi mono e doppia parete.
- Compensation opening with protection for SW or DW collective systems and double wall.

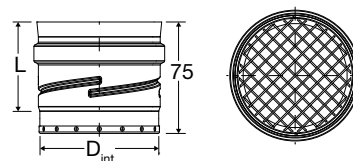
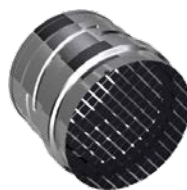

| Cod. | D _{int} | L | |
|-----------|------------------|----|---|
| OL0160381 | 80 | 60 | 1 |
| OL0160382 | 100 | 60 | 1 |

Da inserire in un T 90°, alla base di una canna collettiva, dal sesto allaccio in poi.
To be inserted in a 90° TEE, at the basis of a collective flue pipe, from the sixth connection onward.

- Raccordo a T 45° maschio.
- 45° male TEE.

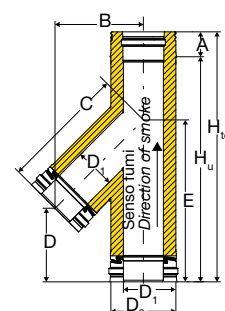

| Cod. inox | Cod. rame/copper | D ₁ | D ₂ | A | B | C | D | E | H _{tot} | H _u | S | |
|-----------|------------------|----------------|----------------|----|-----|-----|-----|-----|------------------|----------------|----|---|
| OL0162221 | OL0162221RA* | 80 | 130 | 50 | 186 | 262 | 98 | 283 | 410 | 360 | 25 | 1 |
| OL0162222 | OL0162222RA* | 100 | 150 | 50 | 204 | 290 | 105 | 309 | 440 | 390 | 25 | 1 |
| OL0162223 | OL0162223RA* | 130 | 180 | 50 | 232 | 327 | 111 | 342 | 480 | 430 | 25 | 1 |
| OL0162224 | OL0162224RA* | 150 | 200 | 50 | 245 | 346 | 124 | 368 | 510 | 460 | 25 | 1 |
| OL0162225 | OL0162225RA* | 180 | 230 | 50 | 270 | 383 | 132 | 402 | 550 | 500 | 25 | 1 |
| OL0162226 | OL0162226RA* | 200 | 250 | 50 | 284 | 402 | 144 | 428 | 490 | 540 | 25 | 1 |

*Aggiungere fascetta stringitubo. - Hose locking band to add. (pag. 165).

- Raccordo T 45°.
- 45° TEE fitting.

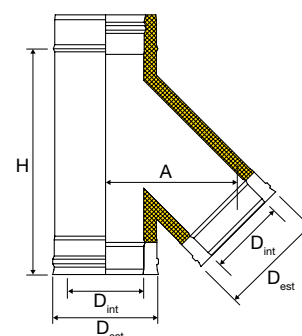

| Cod. inox | Cod. rame/copper | D _{int} | D _{est} | A | H | S | |
|--------------|------------------|------------------|------------------|-----|-----|----|---|
| OL0162227CL* | OL0162227RA* | 250 | 300 | 344 | 560 | 25 | 1 |
| OL0162228CL* | OL0162228RA* | 300 | 350 | 386 | 640 | 25 | 1 |
| OL0162229CL* | OL0162229RA* | 350 | 400 | 496 | 883 | 25 | 1 |
| OL0162230CL* | OL0162230RA* | 400 | 450 | 515 | 940 | 25 | 1 |

*Aggiungere fascetta stringitubo. - Hose locking band to add. (pag. 165).

- Elemento d'ispezione con tappo per temperature fino a 200°C. T200 P1 W.

- *Inspection element with plug up to temperature 200°C. T200 H1 W.*

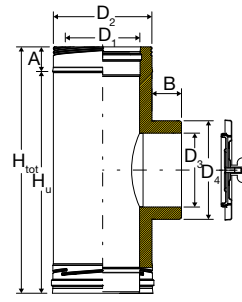

Avvitare - Twist

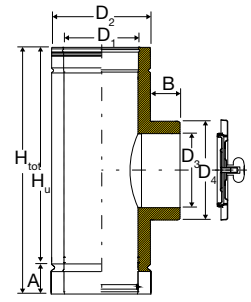

Tradizionale da Ø 250 al Ø 400 mm
Traditional from Ø 250 to Ø 400 mm

| Cod. inox | Cod. rame/copper | D ₁ | D ₂ | D ₃ | D ₄ | A | B | H _{tot} | H _u | |
|--------------|------------------|----------------|----------------|----------------|----------------|----|----|------------------|----------------|---|
| OL0162241 | OL0162241RA* | 80 | 130 | 80 | 130 | 50 | 60 | 494 | 444 | 1 |
| OL0162242 | OL0162242RA* | 100 | 150 | 100 | 150 | 50 | 60 | 494 | 444 | 1 |
| OL0162243 | OL0162243RA* | 130 | 180 | 130 | 180 | 50 | 60 | 494 | 444 | 1 |
| OL0162244 | OL0162244RA* | 150 | 200 | 150 | 200 | 50 | 60 | 494 | 444 | 1 |
| OL0162245 | OL0162245RA* | 180 | 230 | 180 | 230 | 50 | 60 | 494 | 444 | 1 |
| OL0162246 | OL0162246RA* | 200 | 250 | 200 | 250 | 50 | 60 | 494 | 444 | 1 |
| OL0162247CL* | OL0162247RA* | 250 | 300 | 200 | 250 | 50 | 60 | 494 | 440 | 1 |
| OL0162248CL* | OL0162248RA* | 300 | 350 | 200 | 250 | 50 | 60 | 494 | 440 | 1 |
| OL0162249CL* | OL0162249RA* | 350 | 400 | 200 | 250 | 50 | 60 | 494 | 440 | 1 |
| OL0162250CL* | OL0162250RA* | 400 | 450 | 200 | 250 | 50 | 60 | 494 | 440 | 1 |

*Aggiungere fascetta stringitubo. - Hose locking band to add. (pag. 165).

- Elemento con portello d'ispezione per combustibili solidi per temperature fino a 600°C. T600 N1 D.

- *Inspection element with door for solid combustible temperature up to 600°C. T600 P1 D.*

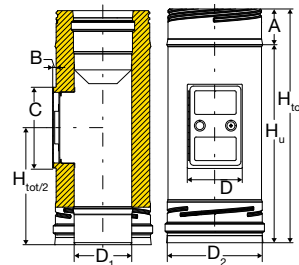

Avvitare - Twist

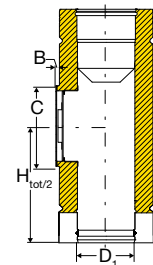

Tradizionale da Ø 250 al Ø 400 mm
Traditional from Ø 250 to Ø 400 mm

| Cod. inox | Cod. rame/copper | D ₁ | D ₂ | A | B | C | D | H _{tot} | H _u | |
|--------------|------------------|----------------|----------------|----|---|-----|-----|------------------|----------------|---|
| OL0162301 | OL0162301RA* | 80 | 130 | 50 | 4 | 175 | 115 | 494 | 444 | 1 |
| OL0162302 | OL0162302RA* | 100 | 150 | 50 | 4 | 175 | 115 | 494 | 444 | 1 |
| OL0162303 | OL0162303RA* | 130 | 180 | 50 | 4 | 175 | 115 | 494 | 444 | 1 |
| OL0162304 | OL0162304RA* | 150 | 200 | 50 | 4 | 175 | 115 | 494 | 444 | 1 |
| OL0162305 | OL0162305RA* | 180 | 230 | 50 | 4 | 175 | 115 | 494 | 444 | 1 |
| OL0162306 | OL0162306RA* | 200 | 250 | 50 | 4 | 175 | 115 | 494 | 444 | 1 |
| OL0162307CL* | OL0162307RA* | 250 | 300 | 54 | 4 | 280 | 185 | 494 | 440 | 1 |
| OL0162308CL* | OL0162308RA* | 300 | 350 | 54 | 4 | 280 | 185 | 494 | 440 | 1 |
| OL0162309CL* | OL0162309RA* | 350 | 400 | 54 | 4 | 280 | 185 | 494 | 440 | 1 |
| OL0162310CL* | OL0162310RA* | 400 | 450 | 54 | 4 | 280 | 185 | 494 | 440 | 1 |

Installare solo con combustibili solidi. - To be used with solid fuel only.

*Aggiungere fascetta stringitubo. - Hose locking band to add. (pag. 165).

- Elemento controllo fumi e temperatura.
- *Smoke and temperature controlling element.*

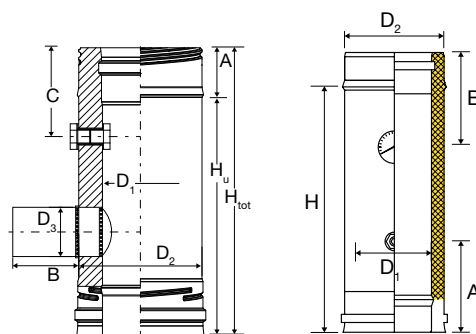

Avvitare - Twist

Tradizionale da Ø 250 al Ø 400 mm
Traditional from Ø 250 to Ø 400 mm

| Cod. inox | Cod. rame/copper | D ₁ | D ₂ | D ₃ | A | B | H _{tot} | H _u | |
|--------------|------------------|----------------|----------------|----------------|----|-----|------------------|----------------|---|
| OL0162345 | OL0162345RA* | 180 | 230 | 60 | 50 | 60 | 494 | 444 | 1 |
| OL0162346 | OL0162346RA* | 200 | 250 | 60 | 50 | 60 | 494 | 444 | 1 |
| OL0162347CL* | OL0162347RA* | 250 | 300 | 60 | 50 | 280 | 494 | 440 | 1 |
| OL0162348CL* | OL0162348RA* | 300 | 350 | 60 | 50 | 280 | 494 | 440 | 1 |
| OL0162349CL* | OL0162349RA* | 350 | 400 | 60 | 50 | 280 | 494 | 440 | 1 |
| OL0162350CL* | OL0162350RA* | 400 | 450 | 60 | 50 | 280 | 494 | 440 | 1 |

*Aggiungere fascetta stringitubo. - *Hose locking band to add.* (pag. 165).

- Elemento prelievo fumi.
- *Smoke sampling element.*

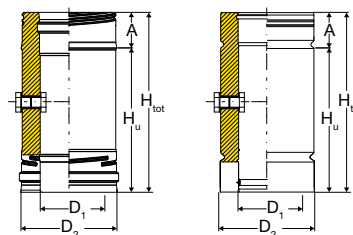

Avvitare - Twist

Tradizionale da Ø 250 al Ø 400 mm
Traditional from Ø 250 to Ø 400 mm

| Cod. inox | Cod. rame/copper | D ₁ | D ₂ | A | H _{tot} | H _u | |
|--------------|------------------|----------------|----------------|----|------------------|----------------|---|
| OL0162281 | OL0162281RA* | 80 | 130 | 50 | 244 | 194 | 1 |
| OL0162282 | OL0162282RA* | 100 | 150 | 50 | 244 | 194 | 1 |
| OL0162283 | OL0162283RA* | 130 | 180 | 50 | 244 | 194 | 1 |
| OL0162284 | OL0162284RA* | 150 | 200 | 50 | 244 | 194 | 1 |
| OL0162285 | OL0162285RA* | 180 | 230 | 50 | 244 | 194 | 1 |
| OL0162286 | OL0162286RA* | 200 | 250 | 50 | 244 | 194 | 1 |
| OL0162287CL* | OL0162287RA* | 250 | 300 | 54 | 244 | 190 | 1 |
| OL0162288CL* | OL0162288RA* | 300 | 350 | 54 | 244 | 190 | 1 |
| OL0162289CL* | OL0162289RA* | 350 | 400 | 54 | 244 | 190 | 1 |
| OL0162290CL* | OL0162290RA* | 400 | 450 | 54 | 244 | 190 | 1 |

*Aggiungere fascetta stringitubo. - *Hose locking band to add.* (pag. 165).

- Scarico condensa verticale.
- Vertical condensation discharge.

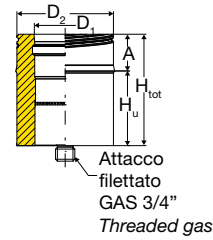

Avvitare - Twist

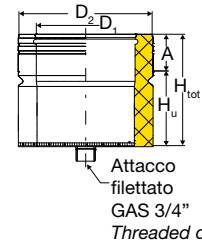

Tradizionale da Ø 250 al Ø 400 mm
Traditional from Ø 250 to Ø 400 mm

| Cod. inox | Cod. rame/copper | D ₁ | D ₂ | A | H _{tot} | H _u | |
|--------------|------------------|----------------|----------------|----|------------------|----------------|---|
| OL0162401 | OL0162401RA* | 80 | 130 | 50 | 130 | 80 | 1 |
| OL0162402 | OL0162402RA* | 100 | 150 | 50 | 130 | 80 | 1 |
| OL0162403 | OL0162403RA* | 130 | 180 | 50 | 130 | 80 | 1 |
| OL0162404 | OL0162404RA* | 150 | 200 | 50 | 130 | 80 | 1 |
| OL0162405 | OL0162405RA* | 180 | 230 | 50 | 130 | 80 | 1 |
| OL0162406 | OL0162406RA* | 200 | 250 | 50 | 130 | 80 | 1 |
| OL0162407CL* | OL0162407RA* | 250 | 300 | 54 | 119 | 65 | 1 |
| OL0162408CL* | OL0162408RA* | 300 | 350 | 54 | 119 | 65 | 1 |
| OL0162409CL* | OL0162409RA* | 350 | 400 | 54 | 119 | 65 | 1 |
| OL0162410CL* | OL0162410RA* | 400 | 450 | 54 | 119 | 65 | 1 |

*Aggiungere fascetta stringitubo. - Hose locking band to add. (pag. 165).

- Piastra partenza con scarico condensa laterale.
- Starting element with lateral condensation discharge.

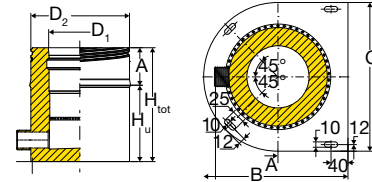

D₁ ≤ 100 - Attacco filettato GAS 1/2" - Threaded gas
D₁ > 100 - Attacco filettato GAS 3/4" - Threaded gas

| Cod. inox | Cod. rame/copper | D ₁ | D ₂ | A | B | C | H _{tot} | H _u | |
|-----------|------------------|----------------|----------------|----|-----|-----|------------------|----------------|---|
| OL0162381 | OL0162381RA* | 80 | 130 | 50 | 220 | 220 | 130 | 70 | 1 |
| OL0162382 | OL0162382RA* | 100 | 150 | 50 | 250 | 250 | 130 | 70 | 1 |
| OL0162383 | OL0162383RA* | 130 | 180 | 50 | 280 | 280 | 130 | 70 | 1 |
| OL0162384 | OL0162384RA* | 150 | 200 | 50 | 280 | 280 | 130 | 70 | 1 |
| OL0162385 | OL0162385RA* | 180 | 230 | 50 | 330 | 330 | 130 | 70 | 1 |
| OL0162386 | OL0162386RA* | 200 | 250 | 50 | 330 | 330 | 130 | 70 | 1 |

*Aggiungere fascetta stringitubo. - Hose locking band to add. (pag. 165).

- Elemento/piastra con scarico laterale.
- Element/base plate with drain plug.

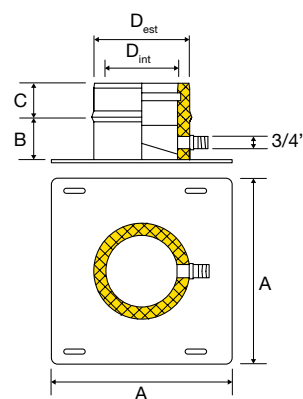
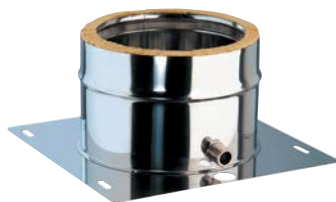

| Cod. inox | Cod. rame/copper | D _{int} | D _{est} | A | B | C | S | |
|--------------|------------------|------------------|------------------|-----|-----|----|----|---|
| OL0162387CL* | OL0162387RA* | 250 | 300 | 400 | 100 | 54 | 25 | 1 |
| OL0162388CL* | OL0162388RA* | 300 | 350 | 450 | 100 | 54 | 25 | 1 |
| OL0162389CL* | OL0162389RA* | 350 | 400 | 500 | 100 | 54 | 25 | 1 |
| OL0162390CL* | OL0162390RA* | 400 | 450 | 550 | 100 | 54 | 25 | 1 |

*Aggiungere fascetta stringitubo. - Hose locking band to add. (pag. 165).

- Supporto a muro completo con scarico condensa.
- Complete intermediate wall support with condensation discharge.

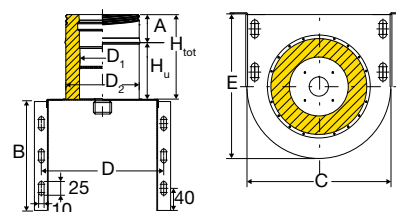

| Cod. inox | Cod. rame/copper | D ₁ | D ₂ | A | B | C | D | E | H _{tot} | H _u | S | |
|-----------|------------------|----------------|----------------|----|-----|-----|-----|-----|------------------|----------------|----|---|
| OL0162441 | OL0162441RA* | 80 | 130 | 50 | 220 | 220 | 242 | 220 | 120 | 70 | 25 | 1 |
| OL0162442 | OL0162442RA* | 100 | 150 | 50 | 250 | 250 | 272 | 250 | 120 | 70 | 25 | 1 |
| OL0162443 | OL0162443RA* | 130 | 180 | 50 | 280 | 280 | 302 | 280 | 120 | 70 | 25 | 1 |
| OL0162444 | OL0162444RA* | 150 | 200 | 50 | 280 | 280 | 302 | 280 | 120 | 70 | 25 | 1 |
| OL0162445 | OL0162445RA* | 180 | 230 | 50 | 330 | 330 | 352 | 330 | 120 | 70 | 25 | 1 |
| OL0162446 | OL0162446RA* | 200 | 250 | 50 | 330 | 330 | 352 | 330 | 120 | 70 | 25 | 1 |

*Aggiungere fascetta stringitubo. - Hose locking band to add. (pag. 165).

- Supporto a muro intermedio completo.
- Complete intermediate wall support.

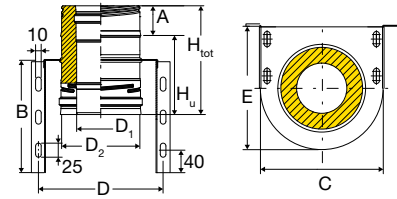

| Cod. inox | Cod. rame/copper | D ₁ | D ₂ | A | B | C | D | E | H _{tot} | H _u | S |  |
|-----------|------------------|----------------|----------------|----|-----|-----|-----|-----|------------------|----------------|----|---|
| OL0162421 | OL0162421RA* | 80 | 130 | 50 | 220 | 220 | 242 | 220 | 244 | 194 | 25 | 1 |
| OL0162422 | OL0162422RA* | 100 | 150 | 50 | 250 | 250 | 272 | 250 | 244 | 194 | 25 | 1 |
| OL0162423 | OL0162423RA* | 130 | 180 | 50 | 280 | 280 | 302 | 280 | 244 | 194 | 25 | 1 |
| OL0162424 | OL0162424RA* | 150 | 200 | 50 | 280 | 280 | 302 | 280 | 244 | 194 | 25 | 1 |
| OL0162425 | OL0162425RA* | 180 | 230 | 50 | 330 | 330 | 352 | 330 | 244 | 194 | 25 | 1 |
| OL0162426 | OL0162426RA* | 200 | 250 | 50 | 330 | 330 | 352 | 330 | 244 | 194 | 25 | 1 |

*Aggiungere fascetta stringitubo. - Hose locking band to add. (pag. 165).

- Supporto a muro intermedio completo di coppia spalle.
- Complete intermediate wall support with brackets (pair).

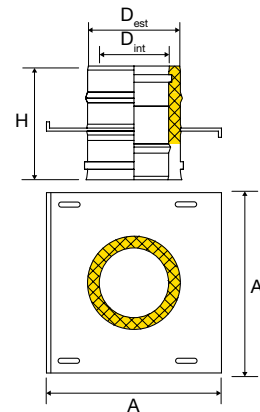

| Cod. | Cod. rame/copper | D _{int} | D _{est} | A | H | S |  |
|--------------|------------------|------------------|------------------|-----|-----|----|---|
| OL0162427CL* | OL0162427RA* | 250 | 300 | 400 | 190 | 25 | 1 |
| OL0162428CL* | OL0162428RA* | 300 | 350 | 450 | 190 | 25 | 1 |
| OL0162429CL* | OL0162429RA* | 350 | 400 | 500 | 190 | 25 | 1 |
| OL0162430CL* | OL0162430RA* | 400 | 450 | 550 | 190 | 25 | 1 |

*Aggiungere fascetta stringitubo. - Hose locking band to add. (pag. 165).

- Riduzione conica.
- Conical reducer.

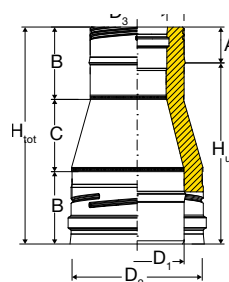

Avvitare - Twist

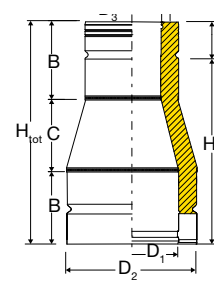

Tradizionale da Ø 250 al Ø 400 mm
Traditional from Ø 250 to Ø 400 mm

Senso Fumi
Direction of smoke

| Cod. inox | Cod. rame/copper | D ₁ | D ₃ | D ₄ | D ₂ | A | B ± 5 mm | C ± 5 mm | H _{tot} ± 5 mm | H _u ± 5 mm | |
|--------------|------------------|----------------|----------------|----------------|----------------|----|----------|----------|-------------------------|-----------------------|---|
| OL0162531 | OL0162531RA* | 130 | 80 | 130 | 180 | 50 | 94 | 100 | 294 | 244 | 1 |
| OL0162532 | OL0162532RA* | 150 | 100 | 150 | 200 | 50 | 94 | 100 | 294 | 244 | 1 |
| OL0162533 | OL0162533RA* | 180 | 130 | 180 | 230 | 50 | 94 | 100 | 294 | 244 | 1 |
| OL0162534 | OL0162534RA* | 200 | 150 | 200 | 250 | 50 | 94 | 100 | 294 | 244 | 1 |
| OL0162535 | OL0162535RA* | 250 | 200 | 250 | 300* | 50 | 94 | 100 | 294 | 244 | 1 |
| OL0162536CL* | OL0162536RA* | 300 | 250 | 300* | 350* | 54 | 94 | 100 | 290 | 240 | 1 |
| OL0162537CL* | OL0162537RA* | 350 | 300 | 350* | 400* | 54 | 95 | 100 | 290 | 240 | 1 |
| OL0162538CL* | OL0162538RA* | 400 | 350 | 400* | 450* | 54 | 95 | 100 | 290 | 240 | 1 |
| OL0162539CL* | OL0162539RA* | 450 | 400 | 450* | 500* | 54 | 95 | 100 | 290 | 240 | 1 |

*Aggiungere fascetta stringitubo. - Hose locking band to add. (pag. 165).

- Aumento conico.
- Conical increasing adapter.

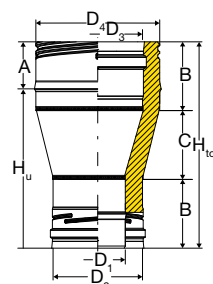

Avvitare - Twist

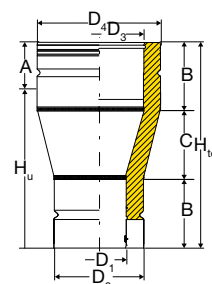

Tradizionale da Ø 250 al Ø 400 mm
Traditional from Ø 250 to Ø 400 mm

Senso Fumi
Direction of smoke

| Cod. inox | Cod. rame/copper | D ₁ | D ₃ | D ₂ | D ₄ | A | B ± 5 mm | C ± 5 mm | H _{tot} ± 5 mm | H _u ± 5 mm | |
|--------------|------------------|----------------|----------------|----------------|----------------|----|----------|----------|-------------------------|-----------------------|---|
| OL0162521 | OL0162521RA* | 80 | 130 | 130 | 180 | 50 | 94 | 100 | 294 | 244 | 1 |
| OL0162522 | OL0162522RA* | 100 | 150 | 150 | 200 | 50 | 94 | 100 | 294 | 244 | 1 |
| OL0162523 | OL0162523RA* | 130 | 180 | 180 | 230 | 50 | 94 | 100 | 294 | 244 | 1 |
| OL0162524 | OL0162524RA* | 150 | 200 | 200 | 250 | 50 | 94 | 100 | 294 | 244 | 1 |
| OL0162530 | OL0162530RA* | 150 | 180 | 200 | 230 | 50 | 94 | 100 | 294 | 244 | 1 |
| OL0162525 | OL0162525RA* | 200 | 250 | 250 | 300* | 50 | 94 | 100 | 290 | 240 | 1 |
| OL0162526CL* | OL0162526RA* | 250 | 300 | 300* | 350* | 54 | 94 | 100 | 290 | 240 | 1 |
| OL0162527CL* | OL0162527RA* | 300 | 350 | 350* | 400* | 54 | 94 | 100 | 290 | 240 | 1 |
| OL0162528CL* | OL0162528RA* | 350 | 400 | 400* | 500* | 54 | 94 | 100 | 290 | 240 | 1 |
| OL0162529CL* | OL0162529RA* | 400 | 450 | 450* | 500* | 54 | 94 | 100 | 290 | 240 | 1 |

*Aggiungere fascetta stringitubo. - Hose locking band to add. (pag. 165).

- Terminale conico.
- Conical roof.

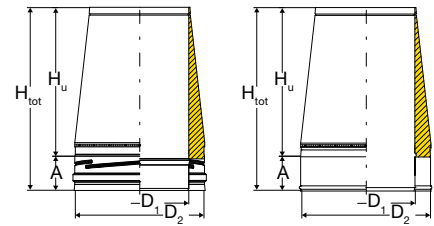

Avvitare - Twist

Tradizionale da Ø 250 al Ø 400 mm
Traditional from Ø 250 to Ø 400 mm

| Cod. inox | Cod. rame/copper | D ₁ | D ₂ | A | H _{tot} ± 5 mm | H _u ± 5 mm | S | |
|--------------|------------------|----------------|----------------|----|-------------------------|-----------------------|----|---|
| OL0162501 | OL0162501RA* | 80 | 130 | 50 | 280 | 230 | 25 | 1 |
| OL0162502 | OL0162502RA* | 100 | 150 | 50 | 280 | 230 | 25 | 1 |
| OL0162503 | OL0162503RA* | 130 | 180 | 50 | 280 | 230 | 25 | 1 |
| OL0162504 | OL0162504RA* | 150 | 200 | 50 | 280 | 230 | 25 | 1 |
| OL0162505 | OL0162505RA* | 180 | 230 | 50 | 280 | 230 | 25 | 1 |
| OL0162506 | OL0162506RA* | 200 | 250 | 50 | 280 | 230 | 25 | 1 |
| OL0162507CL* | OL0162507RA* | 250 | 300 | 65 | 200 | 135 | 25 | 1 |
| OL0162508CL* | OL0162508RA* | 300 | 350 | 65 | 200 | 135 | 25 | 1 |
| OL0162509CL* | OL0162509RA* | 350 | 400 | 65 | 290 | 225 | 25 | 1 |
| OL0162510CL* | OL0162510RA* | 400 | 450 | 65 | 290 | 225 | 25 | 1 |

*Aggiungere fascetta stringitubo. - Hose locking band to add. (pag. 165).

- Terminale antivento/chiuso.
- Anti wind terminal/closed terminal.

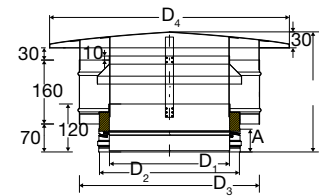

| Cod. inox | Cod. rame/copper | D ₁ | D ₂ | D ₃ | D ₄ | A | H _{tot} | |
|-----------|------------------|----------------|----------------|----------------|----------------|----|------------------|---|
| OL0162481 | OL0162481RA* | 80 | 130 | 230 | 380 | 50 | 300 | 1 |
| OL0162482 | OL0162482RA* | 100 | 150 | 250 | 400 | 50 | 300 | 1 |
| OL0162483 | OL0162483RA* | 130 | 180 | 280 | 430 | 50 | 300 | 1 |
| OL0162484 | OL0162484RA* | 150 | 200 | 300 | 450 | 50 | 300 | 1 |
| OL0162485 | OL0162485RA* | 180 | 230 | 330 | 480 | 50 | 300 | 1 |
| OL0162486 | OL0162486RA* | 200 | 250 | 350 | 500 | 50 | 300 | 1 |

*Aggiungere fascetta stringitubo. - Hose locking band to add. (pag. 165).

- Terminale antivento/chiuso.
- *Anti wind/closed terminal.*

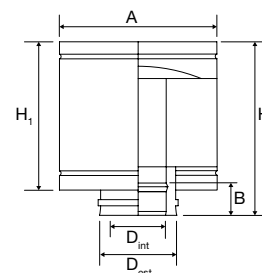

| Cod. | Cod. rame/copper | D _{int} | D _{est} | A | B | H | H ₁ | S | |
|--------------|------------------|------------------|------------------|-----|----|-----|----------------|----|---|
| OL0162487CL* | OL0162487RA* | 250 | 300 | 470 | 65 | 400 | 310 | 25 | 1 |
| OL0162488CL* | OL0162488RA* | 300 | 350 | 530 | 65 | 400 | 310 | 25 | 1 |
| OL0162489CL* | OL0162489RA* | 350 | 400 | 800 | 65 | 420 | 330 | 25 | 1 |
| OL0162490CL* | OL0162490RA* | 400 | 450 | 900 | 65 | 420 | 330 | 25 | 1 |

*Aggiungere fascetta stringitubo. - *Hose locking band to add.* (pag. 165).

- Terminale aperto /cinese/ parapiovvia.
- *Rain cap/open.*

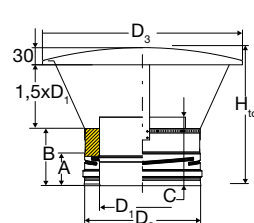

Avvitare - Twist

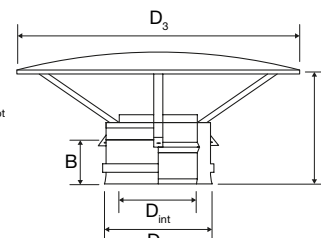

Tradizionale da Ø 250 al Ø 400 mm
Traditional from Ø 250 to Ø 400 mm

| Cod. inox | Cod. rame/copper | D ₁ | D ₂ | D ₃ | A | B ± 5 mm | C ± 5 mm | H _{tot} | |
|--------------|------------------|----------------|----------------|----------------|----|----------|----------|------------------|---|
| OL0162461 | OL0162461RA* | 80 | 130 | 315 | 50 | 100 | 120 | 250 | 1 |
| OL0162462 | OL0162462RA* | 100 | 150 | 315 | 50 | 100 | 120 | 280 | 1 |
| OL0162463 | OL0162463RA* | 130 | 180 | 350 | 50 | 100 | 120 | 325 | 1 |
| OL0162464 | OL0162464RA* | 150 | 200 | 350 | 50 | 100 | 120 | 355 | 1 |
| OL0162465 | OL0162465RA* | 180 | 230 | 400 | 50 | 100 | 120 | 400 | 1 |
| OL0162466 | OL0162466RA* | 200 | 250 | 440 | 50 | 100 | 120 | 430 | 1 |
| OL0162467CL* | OL0162467RA* | 250 | 300 | 500 | 65 | 100 | 120 | 285 | 1 |
| OL0162468CL* | OL0162468RA* | 300 | 350 | 600 | 65 | 100 | 120 | 310 | 1 |
| OL0162469CL* | OL0162469RA* | 350 | 400 | 720 | 65 | 100 | 120 | 310 | 1 |
| OL0162470CL* | OL0162470RA* | 400 | 450 | 850 | 65 | 100 | 120 | 330 | 1 |

*Aggiungere fascetta stringitubo. - *Hose locking band to add.* (pag. 165).

- Silenziatore.
- *Silencer.*

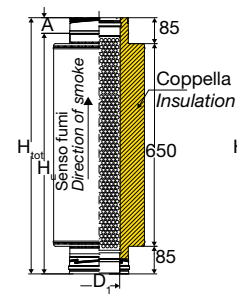

| Cod. inox | D ₁ | D ₂ | D ₃ | A ± 3 mm | H _{tot} | H _u | |
|-----------|----------------|----------------|----------------|----------|------------------|----------------|---|
| OL0162361 | 80 | 130 | 230 | 50 | 820 | 770 | 1 |
| OL0162362 | 100 | 150 | 250 | 50 | 820 | 770 | 1 |
| OL0162363 | 130 | 180 | 280 | 50 | 820 | 770 | 1 |
| OL0162364 | 150 | 200 | 300 | 50 | 820 | 770 | 1 |
| OL0162365 | 180 | 230 | 330 | 50 | 820 | 770 | 1 |
| OL0162366 | 200 | 250 | 350 | 50 | 820 | 770 | 1 |

- Giunto da mono a doppio.
- *Adapter from SW to DW.*

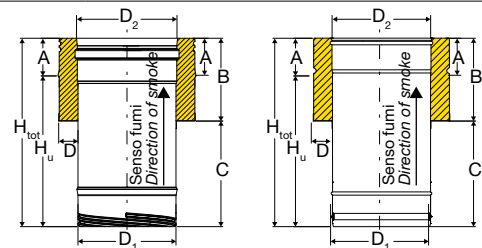

Avvitare - Twist

Tradizionale da Ø 250 al Ø 400 mm
Traditional from Ø 250 to Ø 400 mm

| Cod. inox | Cod. rame/copper | D ₁ (maschio/male) | D ₂ (femmina/female) | A | B | C | D | H _{tot} | H _u | |
|--------------|------------------|-------------------------------|---------------------------------|----|-----|-----|----|------------------|----------------|---|
| OL0162541 | OL0162541RA* | 80 | 80/130 | 50 | 120 | 100 | 25 | 250 | 180 | 1 |
| OL0162542 | OL0162542RA* | 100 | 100/150 | 50 | 120 | 100 | 25 | 250 | 180 | 1 |
| OL0162543 | OL0162543RA* | 130 | 130/180 | 50 | 120 | 100 | 25 | 250 | 180 | 1 |
| OL0162544 | OL0162544RA* | 150 | 150/200 | 50 | 120 | 100 | 25 | 250 | 180 | 1 |
| OL0162545 | OL0162545RA* | 180 | 180/230 | 50 | 120 | 100 | 25 | 250 | 180 | 1 |
| OL0162546 | OL0162546RA* | 200 | 200/250 | 50 | 120 | 100 | 25 | 250 | 180 | 1 |
| OL0162547CL* | OL0162547RA* | 250 | 250/300 | 54 | 120 | 80 | 25 | 160 | 106 | 1 |
| OL0162548CL* | OL0162548RA* | 300 | 300/350 | 54 | 120 | 80 | 25 | 160 | 106 | 1 |
| OL0162549CL* | OL0162549RA* | 350 | 350/400 | 54 | 120 | 80 | 25 | 160 | 106 | 1 |
| OL0162550CL* | OL0162550RA* | 400 | 400/450 | 54 | 120 | 80 | 25 | 160 | 106 | 1 |

*Aggiungere fascetta stringitubo. - *Hose locking band to add.* (pag. 165).

- Giunto da doppio a mono.
- Adapter from DP to SW.

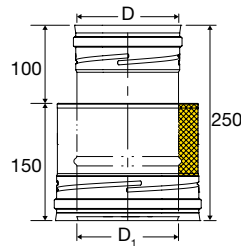

Da Ø 80 a Ø 230 mm
From Ø 80 to Ø 230 mm

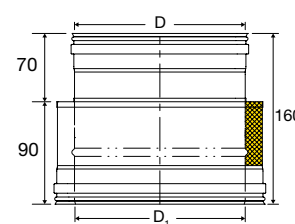

Da Ø 250 a Ø 400 mm
From Ø 250 to Ø 400 mm

| Cod. inox | Cod. rame/copper | D ₁ (maschio/male) | D (femmina/female) | |
|--------------|------------------|-------------------------------|--------------------|---|
| OL0162551 | OL0162551RA* | 80/130 | 80 | 1 |
| OL0162552 | OL0162552RA* | 100/150 | 100 | 1 |
| OL0162553 | OL0162553RA* | 130/180 | 130 | 1 |
| OL0162554 | OL0162554RA* | 150/200 | 150 | 1 |
| OL0162555 | OL0162555RA* | 180/230 | 180 | 1 |
| OL0162556 | OL0162556RA* | 200/250 | 200 | 1 |
| OL0162557CL* | OL0162557RA* | 250/300 | 250 | 1 |
| OL0162558CL* | OL0162558RA* | 300/350 | 300 | 1 |
| OL0162559CL* | OL0162559RA* | 350/400 | 350 | 1 |
| OL0162560CL* | OL0162560RA* | 400/450 | 400 | 1 |

*Aggiungere fascetta stringitubo. - Hose locking band to add. (pag. 165).

Accessori - Accessories

- Faldale piano.
- Flat flashing.

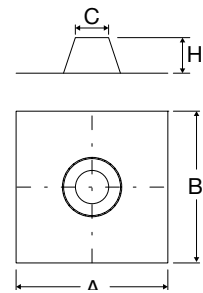

| Cod. | Cod. rame/copper | D _{int} | D _{est} | C | A | B | |
|-----------|------------------|------------------|------------------|-----|-----|-----|---|
| OL0170204 | OL0170204RA | 80 | 130 | 140 | 640 | 640 | 1 |
| OL0170206 | OL0170206RA | 100 | 150 | 160 | 660 | 660 | 1 |
| OL0170208 | OL0170208RA | 130 | 180 | 190 | 690 | 690 | 1 |
| OL0170209 | OL0170209RA | 150 | 200 | 210 | 710 | 710 | 1 |
| OL0170219 | OL0170219RA | 180 | 230 | 240 | 740 | 740 | 1 |
| OL0170210 | OL0170210RA | 200 | 250 | 260 | 760 | 760 | 1 |
| OL0170211 | OL0170211RA | 250 | 300 | 310 | 810 | 810 | 1 |
| OL0170212 | OL0170212RA | 300 | 350 | 360 | 860 | 860 | 1 |
| OL0170213 | - | 350 | 400 | 410 | 910 | 910 | 1 |
| OL0170214 | - | 400 | 450 | 460 | 960 | 960 | 1 |

- Faldale 5°/30°.
- 5°/30° flashing.

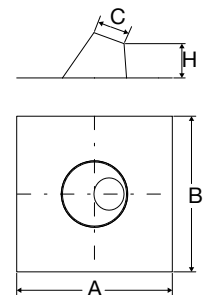

| Cod. | Cod. rame/copper | D _{int} | D _{est} | C | A | B | |
|-----------|------------------|------------------|------------------|-----|------|------|---|
| OL0170304 | OL0170304RA | 80 | 130 | 140 | 680 | 680 | 1 |
| OL0170306 | OL0170306RA | 100 | 150 | 160 | 700 | 700 | 1 |
| OL0170308 | OL0170308RA | 130 | 180 | 190 | 730 | 730 | 1 |
| OL0170309 | OL0170309RA | 150 | 200 | 210 | 750 | 750 | 1 |
| OL0170319 | OL0170319RA | 180 | 230 | 240 | 780 | 780 | 1 |
| OL0170310 | OL0170310RA | 200 | 250 | 260 | 800 | 800 | 1 |
| OL0170311 | OL0170311RA | 250 | 300 | 310 | 850 | 850 | 1 |
| OL0170312 | OL0170312RA | 300 | 350 | 360 | 900 | 900 | 1 |
| OL0170313 | OL0170313RA | 350 | 400 | 410 | 950 | 950 | 1 |
| OL0170314 | OL0170314RA | 400 | 450 | 460 | 1000 | 1000 | 1 |

- Faldale 30°/45°.
- 30°/45° flashing.

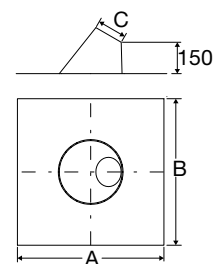

| Cod. | Cod. rame/copper | D _{int} | D _{est} | C | A | B | |
|-----------|------------------|------------------|------------------|-----|------|------|---|
| OL0170404 | OL0170404RA | 80 | 130 | 140 | 700 | 700 | 1 |
| OL0170406 | OL0170406RA | 100 | 150 | 150 | 720 | 720 | 1 |
| OL0170408 | OL0170408RA | 130 | 180 | 190 | 750 | 750 | 1 |
| OL0170409 | OL0170409RA | 150 | 200 | 210 | 770 | 770 | 1 |
| OL0170419 | OL0170419RA | 180 | 230 | 240 | 800 | 800 | 1 |
| OL0170410 | OL0170410RA | 200 | 250 | 260 | 820 | 820 | 1 |
| OL0170411 | OL0170411RA | 250 | 300 | 310 | 870 | 870 | 1 |
| OL0170412 | OL0170412RA | 300 | 350 | 360 | 920 | 920 | 1 |
| OL0170413 | OL0170413RA | 350 | 400 | 410 | 970 | 970 | 1 |
| OL0170414 | OL0170414RA | 400 | 450 | 460 | 1020 | 1020 | 1 |

- Fascia anti acqua.
- Anti-water strip.

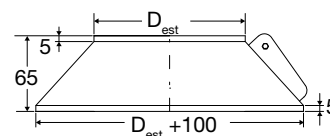

| Cod. | Cod. rame/copper | D _{int} | D _{est} | |
|-----------|------------------|------------------|------------------|---|
| OL0170104 | OL0170104RA | 130 | 131 | 1 |
| OL0170106 | OL0170106RA | 150 | 151 | 1 |
| OL0170108 | OL0170108RA | 180 | 181 | 1 |
| OL0170109 | OL0170109RA | 200 | 201 | 1 |
| OL0170119 | OL0170119RA | 230 | 231 | 1 |
| OL0170110 | OL0170110RA | 250 | 251 | 1 |
| OL0170111 | OL0170111RA | 300 | 301 | 1 |
| OL0170112 | OL0170112RA | 350 | 351 | 1 |
| OL0170113 | OL0170113RA | 400 | 401 | 1 |
| OL0170114 | OL0170114RA | 450 | 451 | 1 |

■ Collare per tiranti.

■ *Clip for rods.*

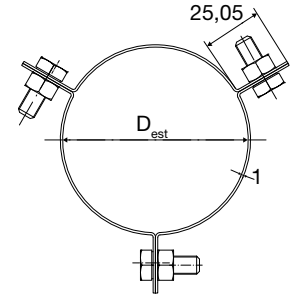

| Cod. | D _{est} |  |
|-----------|------------------|---|
| OL0170004 | 130 | 1 |
| OL0170006 | 150 | 1 |
| OL0170008 | 180 | 1 |
| OL0170009 | 200 | 1 |
| OL0170019 | 230 | 1 |
| OL0170010 | 250 | 1 |
| OL0170011 | 300 | 1 |
| OL0170012 | 350 | 1 |
| OL0170013 | 400 | 1 |
| OL0170014 | 450 | 1 |

■ Supporto a tetto/soletta.

■ *Roof support.*

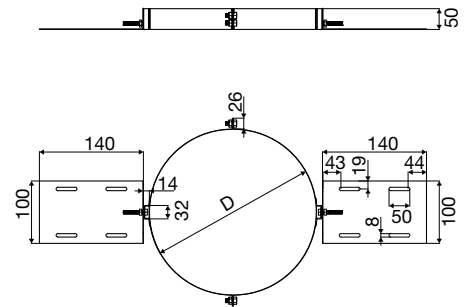

| Cod. | D _{est} |  |
|-----------|------------------|---|
| OL0162581 | 130 | 1 |
| OL0162582 | 150 | 1 |
| OL0162583 | 180 | 1 |
| OL0162584 | 200 | 1 |
| OL0162585 | 230 | 1 |
| OL0162586 | 250 | 1 |
| OL0162587 | 300 | 1 |
| OL0162588 | 350 | 1 |
| OL0162589 | 400 | 1 |
| OL0162590 | 450 | 1 |

■ Fascetta stringitubo.

■ Locking band.

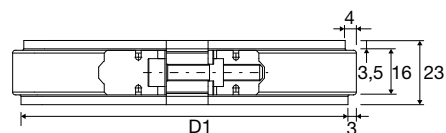

| Cod. | Cod. rame/copper | D | D ₁ | |
|-------------|------------------|-----|----------------|---|
| - | OL0170038RA | 80 | 130 | 1 |
| - | OL0170033RA | 100 | 150 | 1 |
| - | OL0170039RA | 130 | 180 | 1 |
| - | OL0170035RA | 150 | 200 | 1 |
| - | OL0170040RA | 180 | 230 | 1 |
| - | OL0170045RA | 200 | 250 | 1 |
| OL0170077CL | OL0170041RA | 250 | 300 | 1 |
| OL0170078CL | OL0170042RA | 300 | 350 | 1 |
| OL0170079CL | OL0170043RA | 350 | 400 | 1 |
| OL0170080CL | OL0170044RA | 400 | 450 | 1 |

■ Collare di fissaggio a muro.

■ Wall fixing bracket.

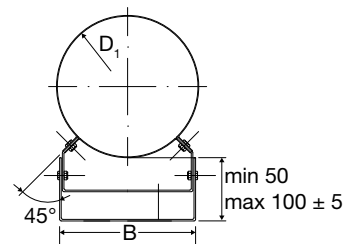

| Cod. | Cod. rame/copper | D ₁ | B | min | max | |
|-----------|------------------|----------------|-----|-----|-----|---|
| OL0162561 | OL0162561RA | 130 | 130 | 50 | 100 | 1 |
| OL0162562 | OL0162562RA | 150 | 150 | 50 | 100 | 1 |
| OL0162563 | OL0162563RA | 180 | 170 | 50 | 100 | 1 |
| OL0162564 | OL0162564RA | 200 | 185 | 50 | 100 | 1 |
| OL0162565 | OL0162565RA | 230 | 220 | 50 | 100 | 1 |
| OL0162566 | OL0162566RA | 250 | 220 | 50 | 100 | 1 |
| OL0162567 | OL0162567RA | 300 | 255 | 50 | 100 | 1 |
| OL0162568 | OL0162568RA | 350 | 290 | 50 | 100 | 1 |
| OL0162569 | OL0162569RA | 400 | 350 | 50 | 100 | 1 |
| OL0162570 | OL0162570RA | 450 | 360 | 50 | 100 | 1 |

- Serranda di regolazione del tiraggio.
- Regulation damper.



ZUK150-ZUK180



ZUK250

| Cod. | Modello Model | Ø serranda Ø damper | Campo di regolazione Regulation range (Pa) | Portata aria Air flow (mc/h) | Portina con apertura antiscoppio Door with anti-explosion opening > 100 Pa |  |
|-----------|------------------|------------------------|--|------------------------------------|--|---|
| OL0170421 | ZUK150 | 150 | 10 - 35 | 130 - 300 | si - yes | 1 |
| OL0170422 | ZUK180 | 180 | 10 - 60 | 190 - 360 | si - yes | 1 |
| OL0170423 | ZUK250 | 410 | 10 - 50 | 220 - 525 | si - yes | 1 |

La serranda di regolazione e stabilizzazione del tiraggio sono caldamente consigliate per i camini/canne fumarie. Stabilizzando il tiraggio si ottiene un incremento del rendimento di combustione dell'apparecchio. Sono particolarmente efficaci nella combustione di biomassa (legna, pellet, cippato ecc.).

Regulation damper and draught stabilization are strongly recommended for chimneys/chimney flues. By stabilising the draught, an increase the performance of the system combustion can be obtained. They are particularly effective in the biomass combustion (wood, pellet, woodchips, etc.).

